

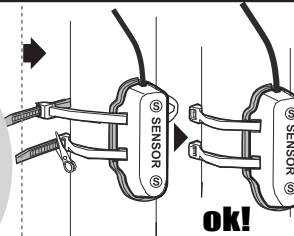

Wired

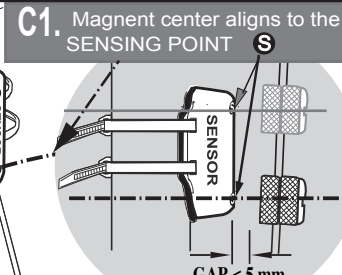
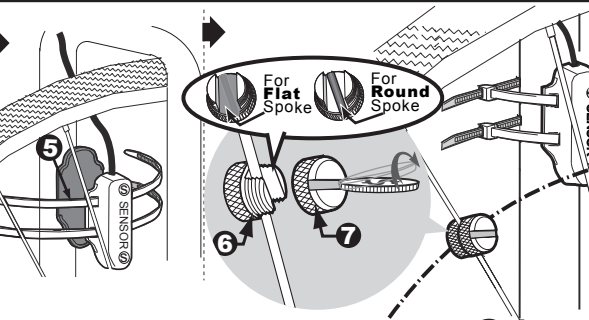
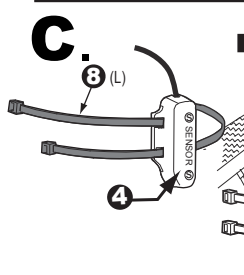
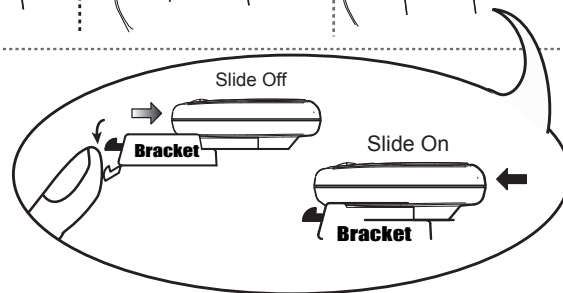
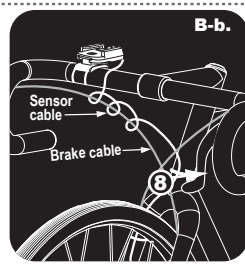
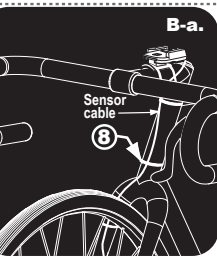
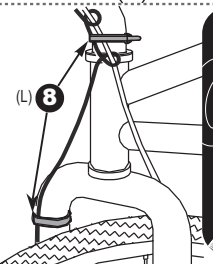
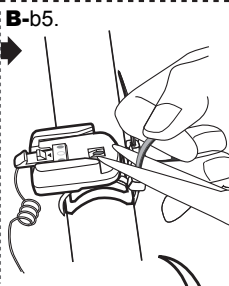
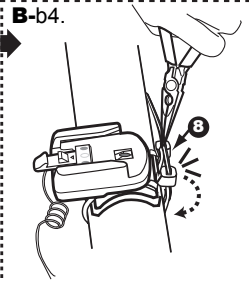
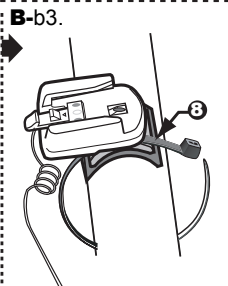
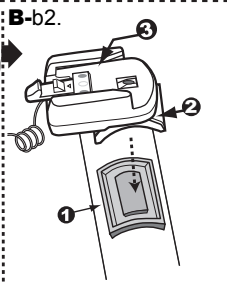
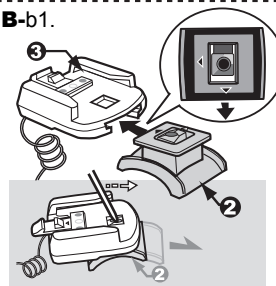
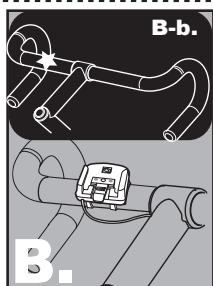
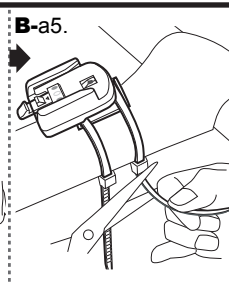
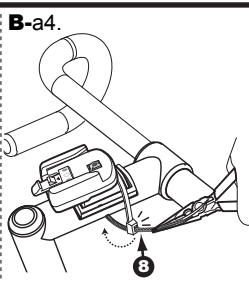
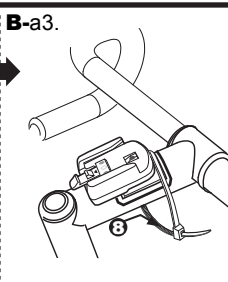
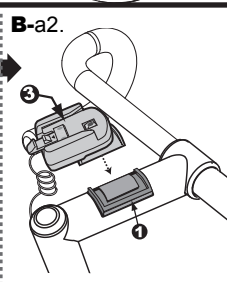
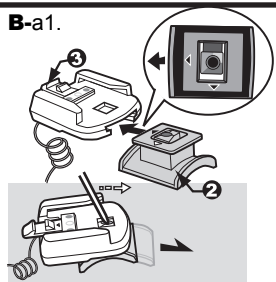
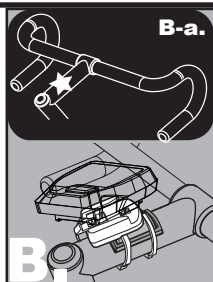
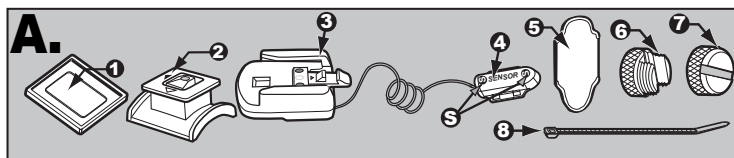
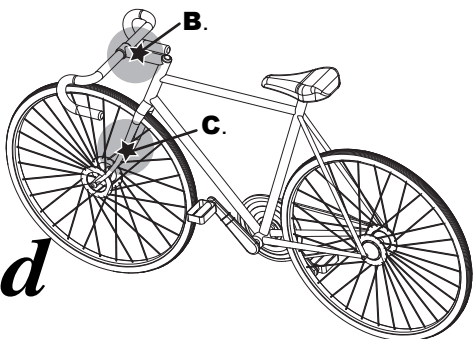

- EN For flat spoke
- DE Für flachspeichen
- FR Pour rayon plat.
- NL Voor platte spaak
- ES Para radios planos
- PT Para raio plano
- IT Per raggio piatto
- HU Lapos küllőhöz
- PL Do płaskich szprych
- CZ Pro ploché paprsek kola
- JP フラット・スポークの場合
- RU Для плоской спицы
- SK Pre ploché lúč
- NO For flat eike
- DK Til flade eger
- FI Litteisiin pinnoihin
- SE För flat eker

- For round spoke
- Für runde speichen
- Pour rayon classique.
- Voor ronde spaak
- Para radios redondos
- Para raio redondo
- Per raggio tondo
- Kerek küllőhöz
- Do okrągłych szprych
- Pro kulatý paprsek kola
- ラウンド・スポークの場合
- Для круглой спицы
- Pre okružly lúč
- For rund eiker
- Til runde eger
- Pyöreisiin pinnoihin
- För rund eker

C1.

- EN Align the center of the MAGNET® to either of the sensing point S.
- DE Richten Sie die Mitte des Magneten® zu einem der Sensorbereich S aus.
- FR Aligned le centre de l'AIMANT® avec une des Point de capture S.
- NL Breng het midden van de MAGNEET® op een lijn met de sensorpunt S.
- ES Alinee el centro del imán® con cualquiera de las Punto sensor S.
- PT ÍMAN® fica alinhado com o centro do ponto de detecção S.
- IT Allineare il centro del magnete® a uno del due punti di rilevazione S del sensore.
- HU A MÁGNES® középpont az érzékelőponthoz igazodik S.
- PL Środek MAGNESU® jest w jednej linii z punktem rejestrującym S.
- CZ Střed MAGNETU® je v zázkrty se snímacím bodem S.
- JP マグネット®の中心を、センサー・ポイント S に合わせます。
- RU Центр МАГНИТА® выравнивается по точке измерения S.
- SK Stred MAGNETU® sa zarovná s bodom snímania S.
- NO MAGNET®-senteret retter seg inn mot avspøkingspunktet S.
- DK MAGNET®-centeret bringes på linie med detekteringspunktet S.
- FI MAGNEETIN® keskusta kohdistetaan tuntopisteeseen S kanssa.
- SE MAGNETENS® centrum är inriktad mot kännarpunkten S.