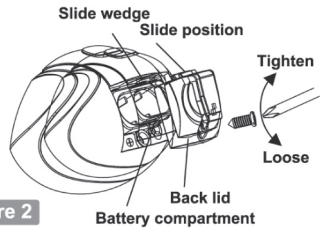
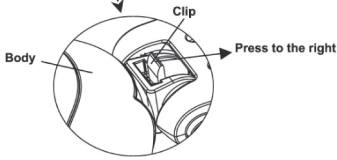
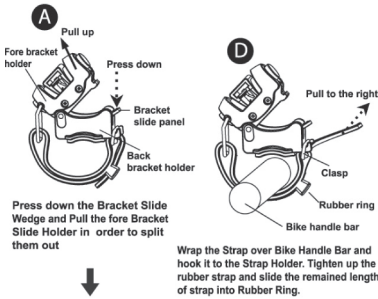

**Figure 1**



**Figure 2**



Press down the Bracket Slide Wedge and Pull the fore Bracket Slide Holder in order to split them out

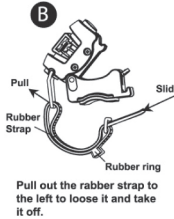

Pull out the rubber strap to the left to loose it and take it off.



Pull the strap to the max.length but make sure it still remains in the Strap Holder.

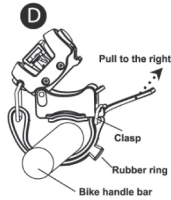

Wrap the Strap over Bike Handle Bar and hook it to the Strap Holder. Tighten up the rubber strap and slide the remained length of strap into Rubber Ring.

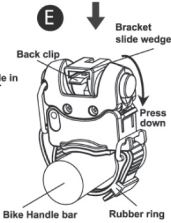

Press back the Fore Bracket Holder to the Back Bracket Holder.

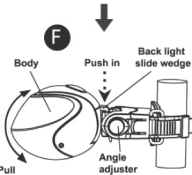

Push the Tail Light into the Bracket Slide Wedge, a "click" sound would be heard once installation done correctly. Press the adjuster with both fingers to adjust the Tail Light to the proper angle for operation.

**Attentions**

1. Make sure the power's off when not in use.
2. Spray resistant, DO NOT dip it into water to avoid any damage.
3. Take out the battery while storage.

**Specifications**

1. Working Power/ 3.0 V DC/ Max.power/150mW
2. Powered by UM-3"AAA"SIZE x 2pc

